

Details of Connector

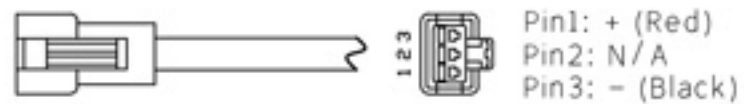

Connector Type: SMP-03V-B (Light Side)
SMP-03V-BC (Power Supply Side)

Specification:

MODEL	YL-R12090-90-W/-UV-B/-G/-Y/-R/-IR850/-IR940
Wavelength (nm)	6500K (Color temperature) / 390/470/525/590/625/850/940
Power Supply	DC24V/13 (W)

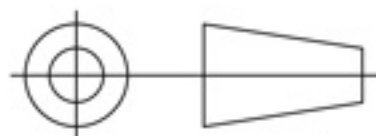

Itemref	Quantity	Material: AL/ACRIL	ArticleNo./Reference	
			Filename YL-R12090-90	Scale 1/1
			YL-R12090-90	
			YL-R12090-90-0000	Edition VER1.0